

Bill Watson suggested the Seal Cart for Lot Props, and sent some plans. We also have the Bob Clark plan which lacks some detail of construction, information I am filling in, and finally, we have Jean LeRoy's comments from his 1949 LCW "Wagon Shop." These drawings are done in $\frac{3}{4}" = 1'$ scale. Even though this cart may appear simple, to get it to collapse into a single package is not that easy, especially in buidling a working model. This would be practical only when using stake pockets all the way around for the small scales. In this plan the only separate part is the end gate which becomes the ramp as you will see in the drawings.

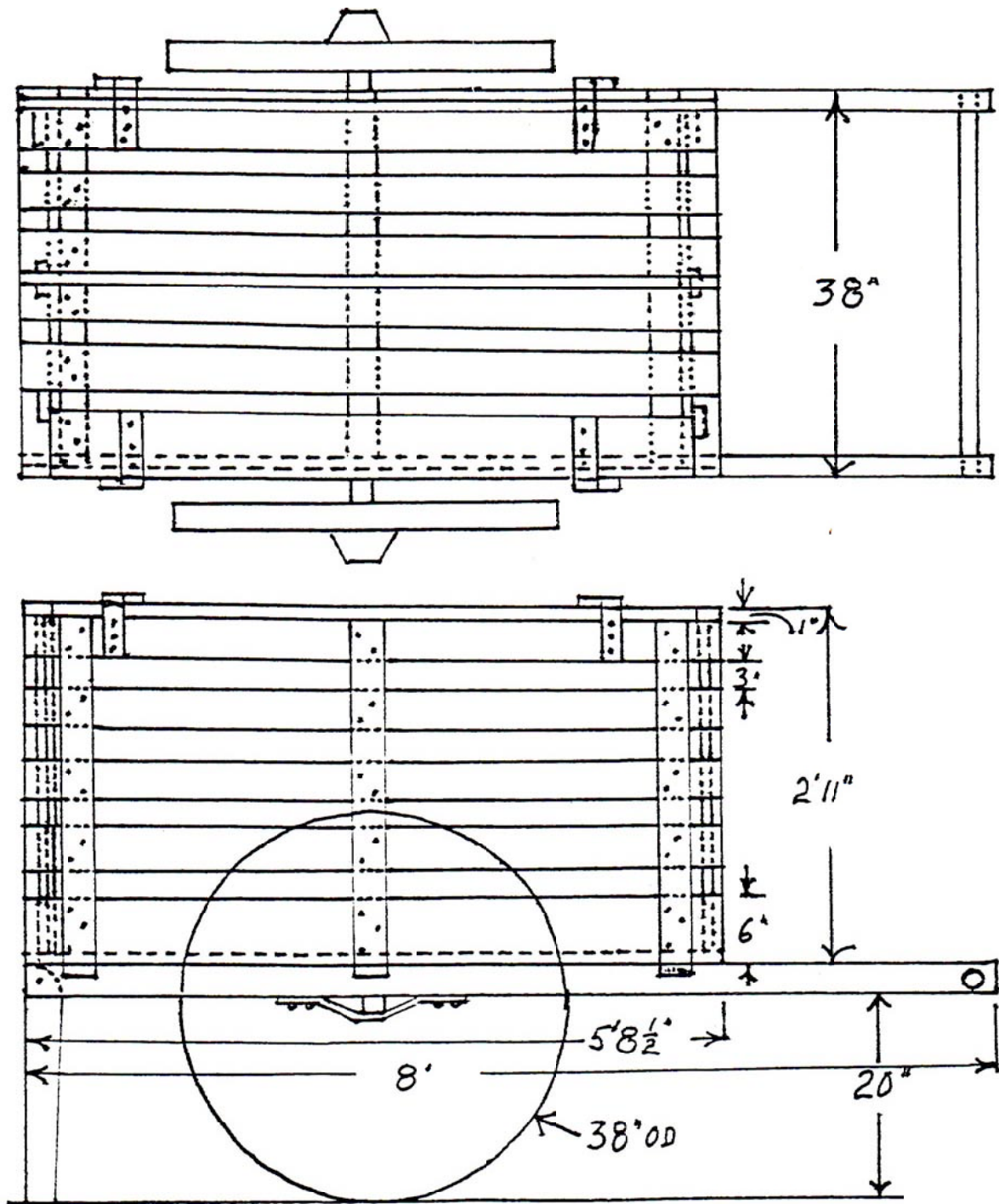

Seal Transfer Cart

DATE: 1949	SCALE: $\frac{3}{4}" = 1'$	SCANNED & REVISED: 10/17/2016	Pg 1 of 6
Circus Model Builders			
Drawn By David L. Hill - CMB 1055			DRAWING NUMBER #0371

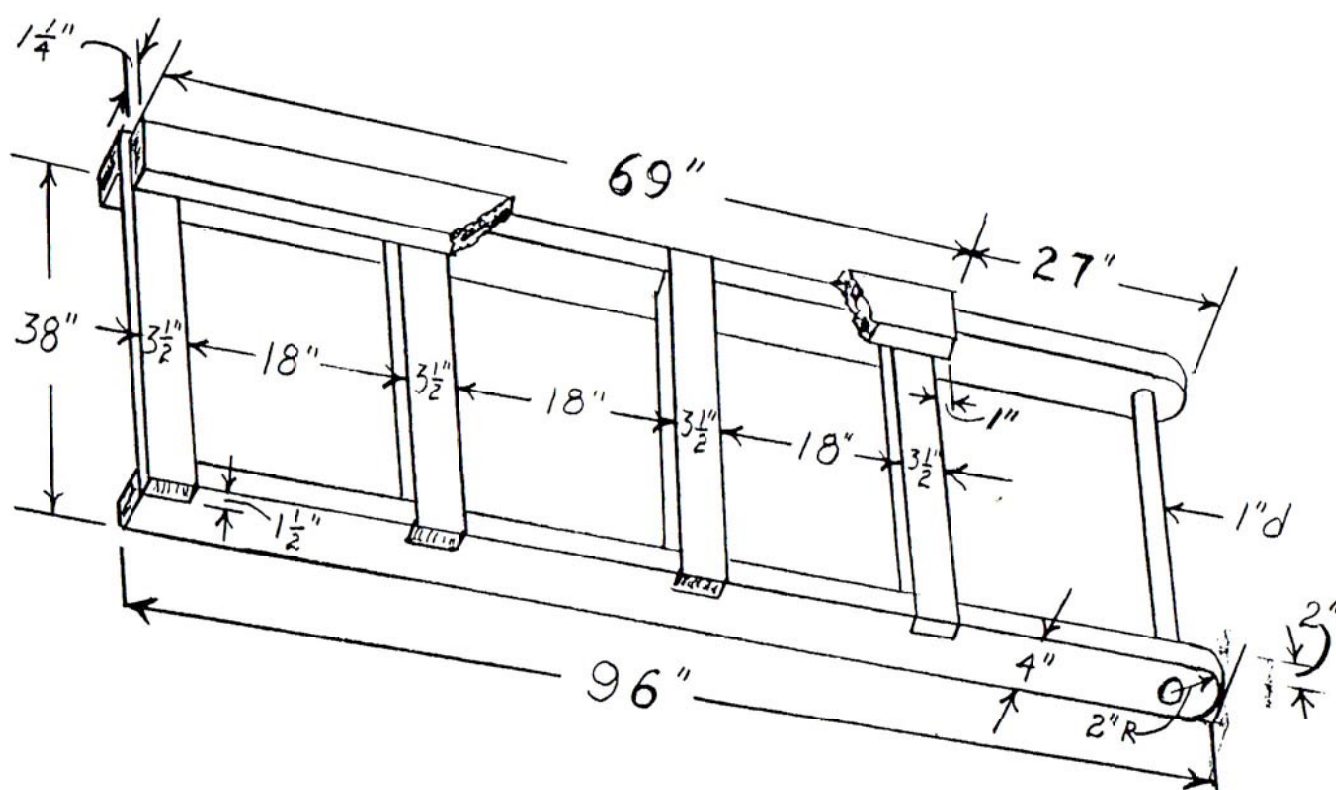
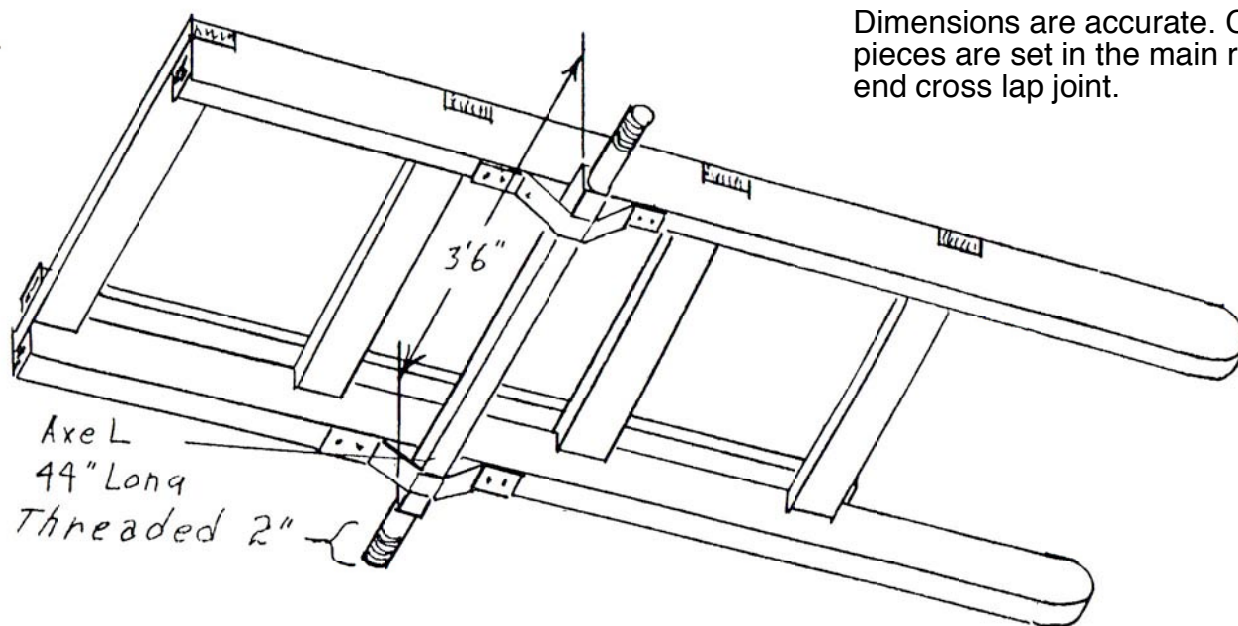

Seal Transfer Cart

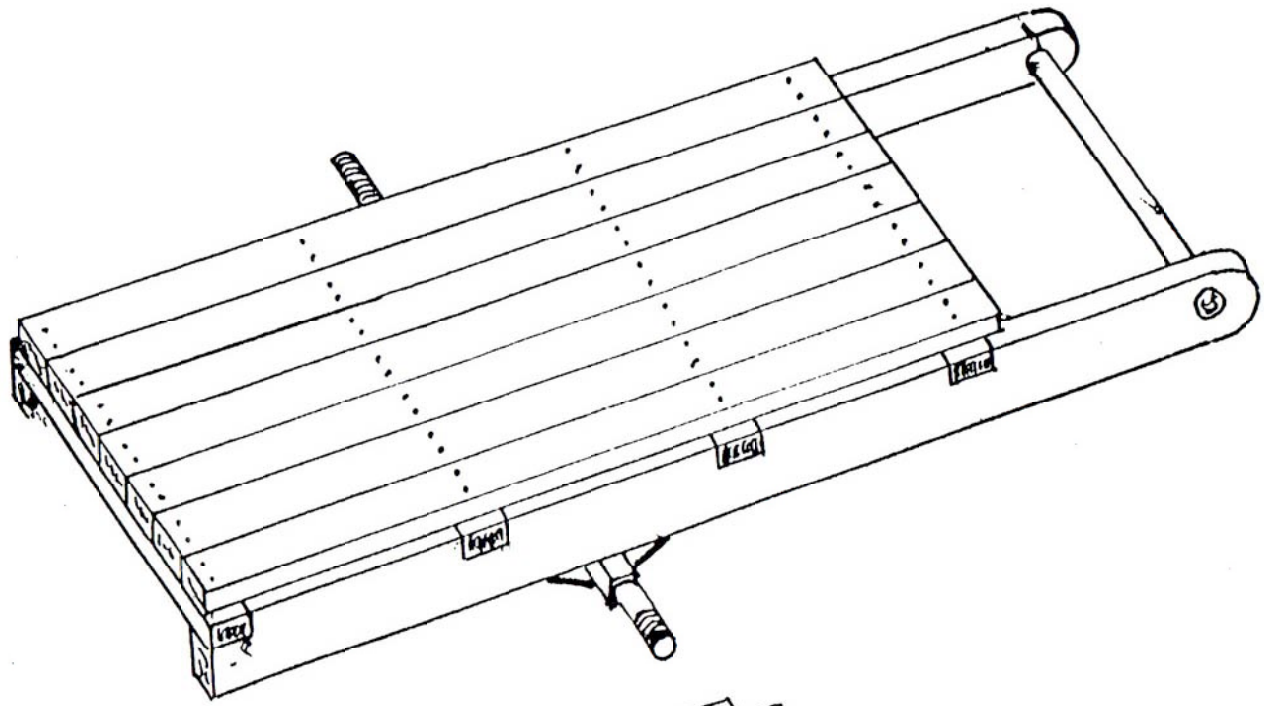

(Drawings are not accurate scale.)

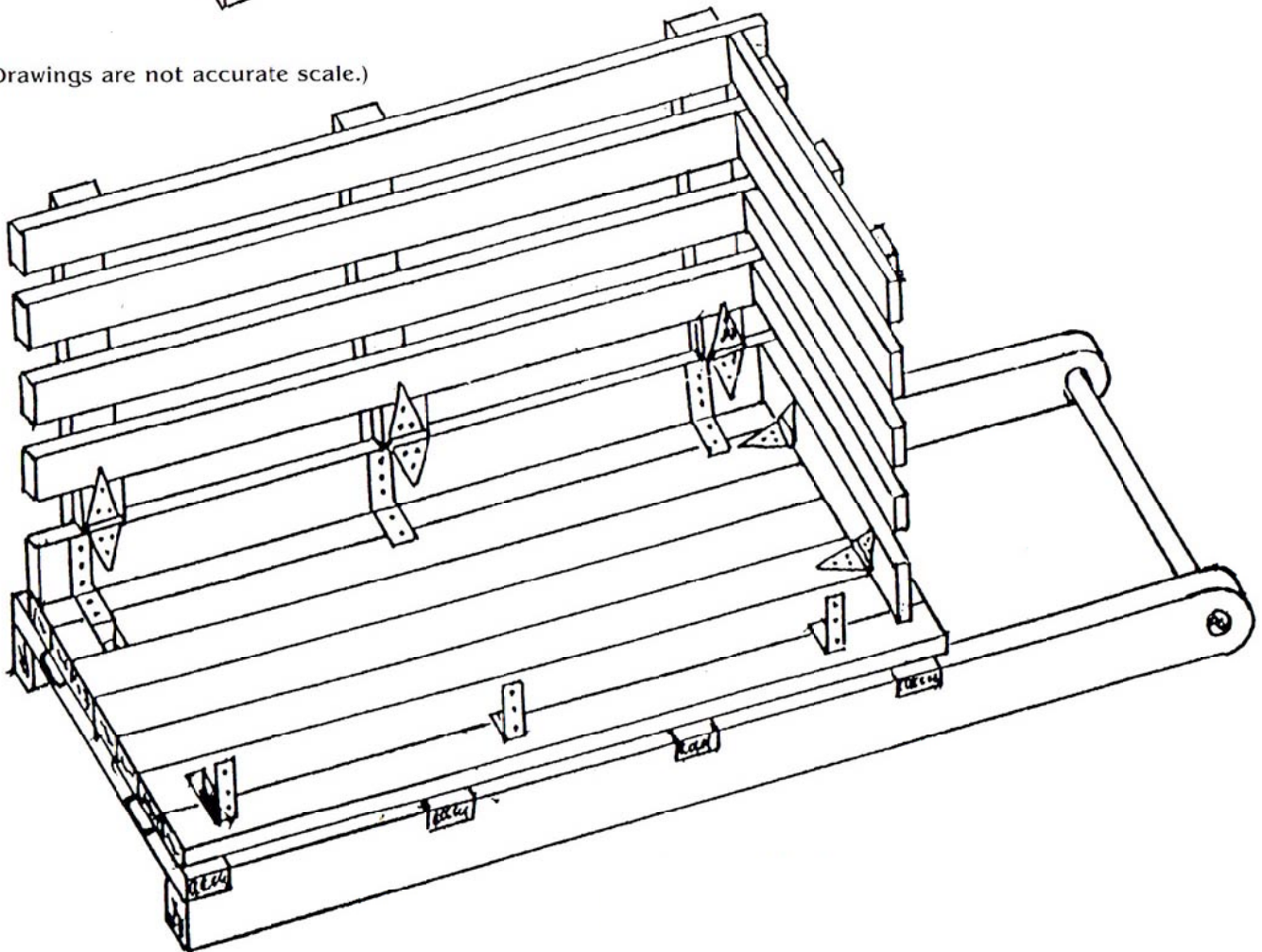

Seal Transfer Cart

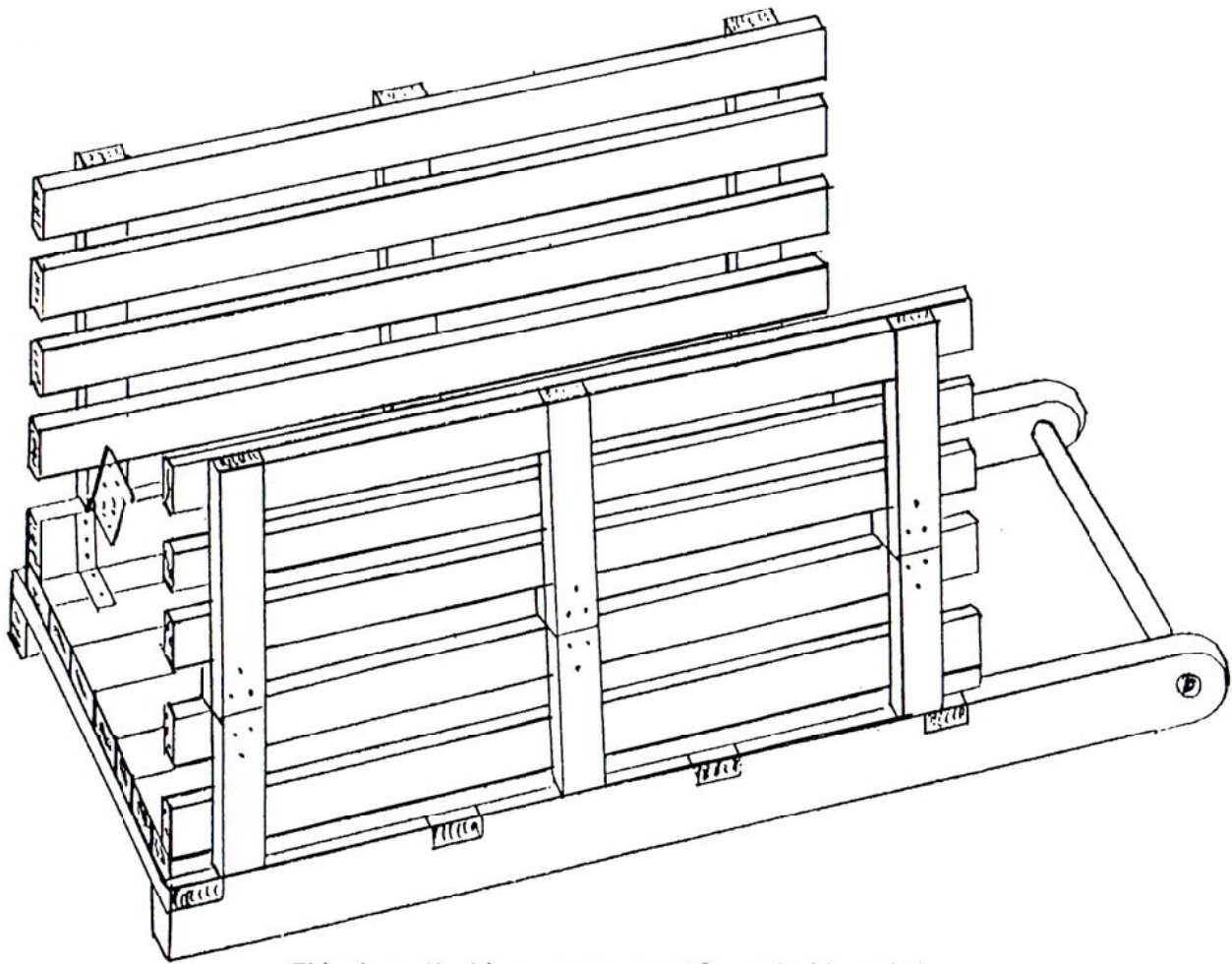

This shows the hinge arrangement for each side and also the Removable Rear Tailgate. The holes in floor for Rear Tailgate are shown in bottom diagram of Sheet #3.

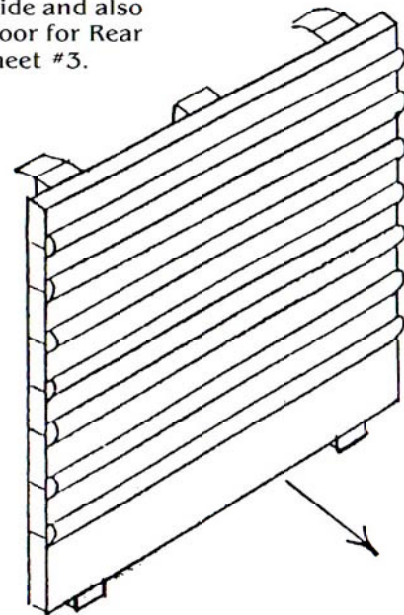
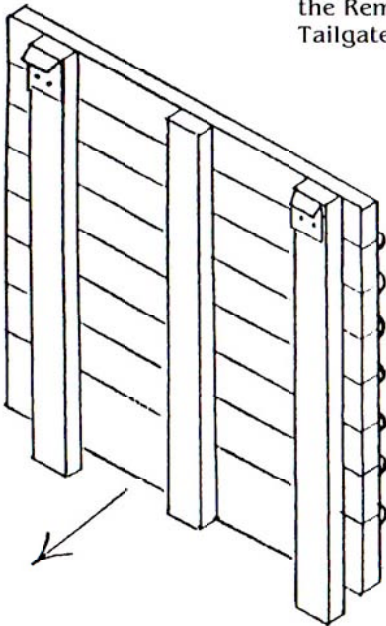

Seal Transfer Cart

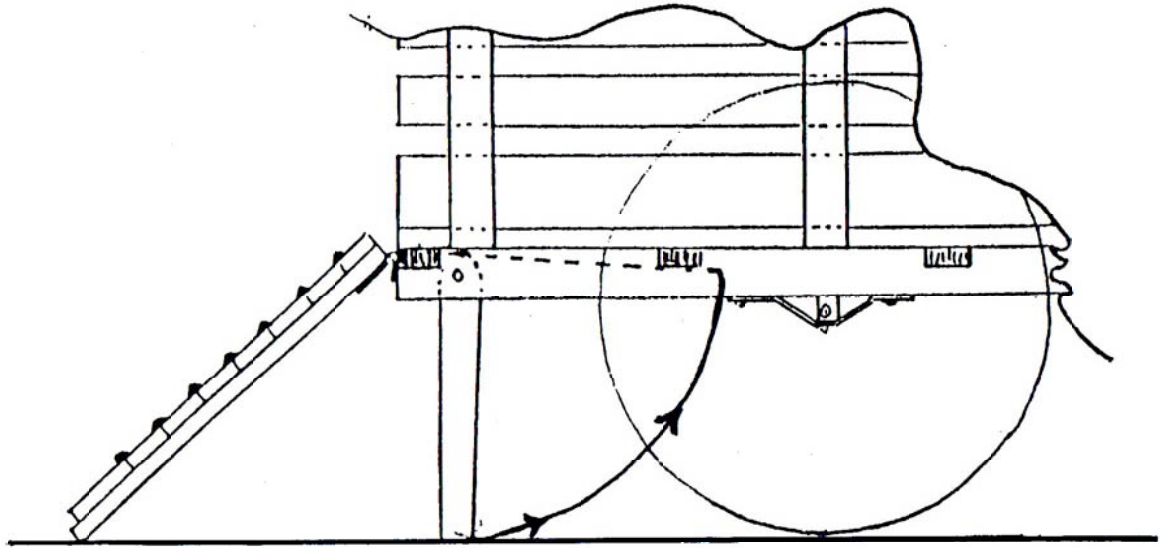

The top drawings illustrate the operation of the Tail Gate. You will note in the copy that the Tail Gate is the only part that is removable, as it sets in 3 pockets in the floor. When it is removed for use, the hooks on top are hooked into brackets on the back edge of the floor. Note the end view which looks to the front panel showing front panel hinges for folding down.

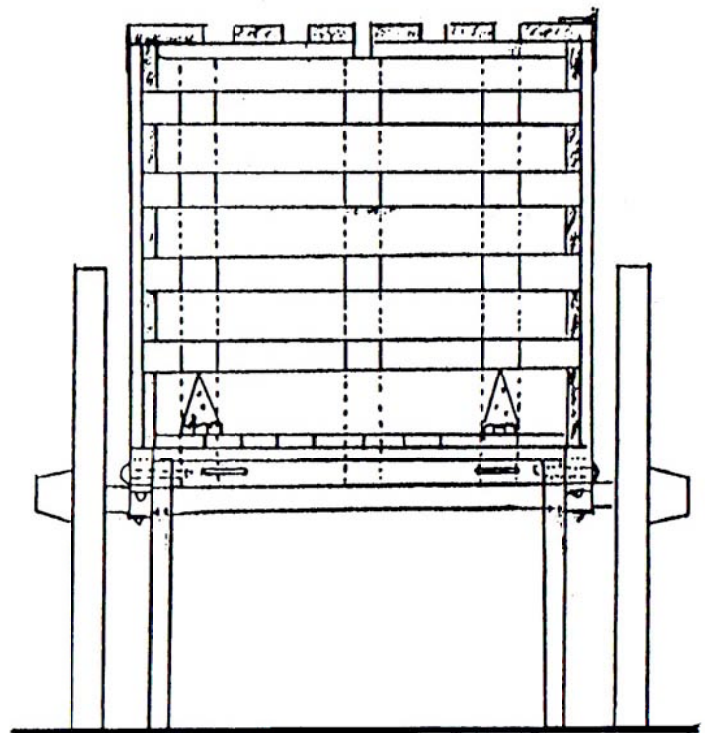

This plan drawing sponsored by Theo Davis IV - our sincere thanks.

Seal Transfer Cart

Greetings from the Lot Prop. Man. Well, this is the last of the sheets (#6) for the Collapsible Seal Transfer Cart. In this last plan sheet we have the top view of the entire cart and the end view showing how the top pieces are hinged to fold against the sides. Notice the one side folds to the inside and the opposite side folds to the outside. With the front panel hinged at floor (see page 3) it folds down against the floor. The tail gate is removed and also put on floor back end. We now fold the side with lower hinges first and then the opposite side. You will also see that the support legs can be swung up under the body and the only remaining protrusion are the wheel. When put on top of an open wagon it is usually upside down. I hope you have found this interesting and an intriguing plan.

TOP VIEW

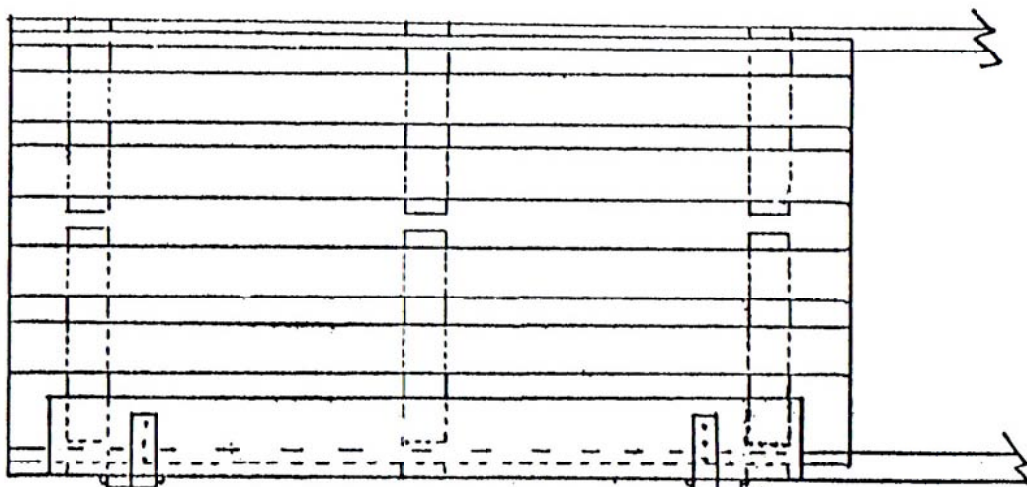

END VIEW

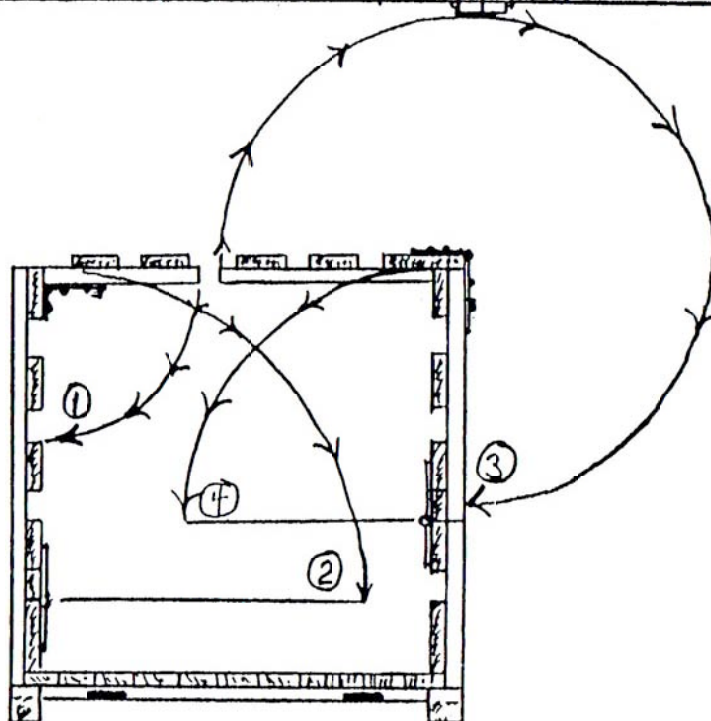

This plan drawing sponsored by Theo Davis IV - our sincere thanks.

Seal Transfer Cart