

#1

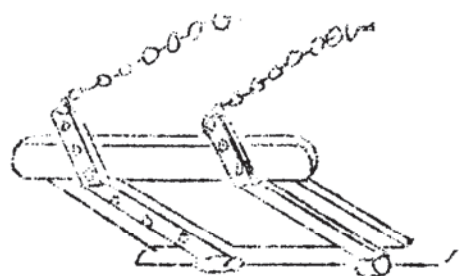

Foot Board Held Up By Chains

#2

Hinges On Top Of "X"

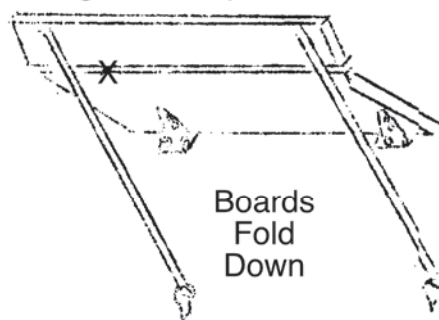
Boards
Fold
Down

#3

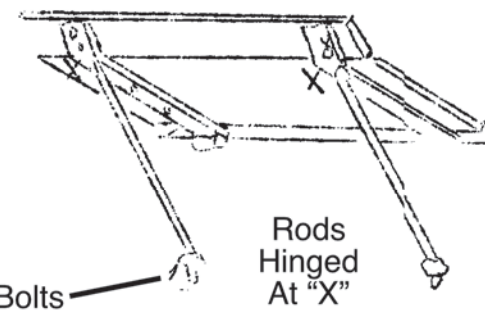

Eye Bolts

Rods
Hinged
At "X"

FOOT BOARDS - This covers the most common types of foot boards.

No. 1 was used on many of the Barnes, Sells-Floto & Hagenbeck-Wallace wagons.

No. 2 was used on cages and on most of the old Ringling wagons. No 2 uses (4) hinges. The ones between the boards are on opposite of the board from hinges used to attach foot boards to the wagon.

No. 3 is similar to No. 2 except that support rods are hinged to footboard and the board is in one piece. This one was found on an old John Robinson cage.

#1

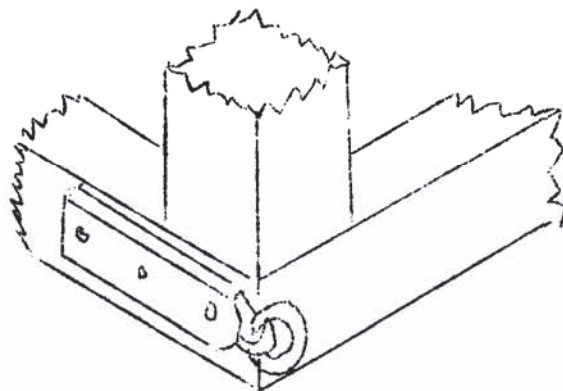

#2

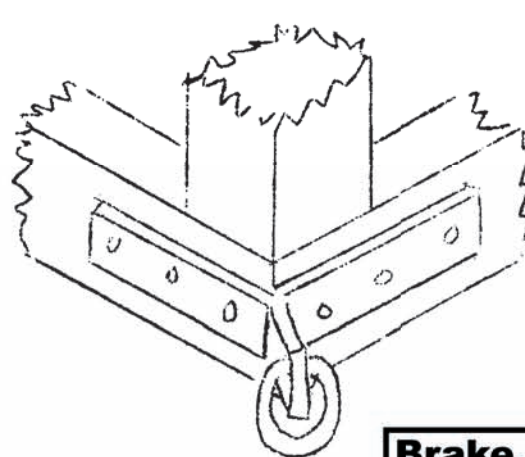

#3

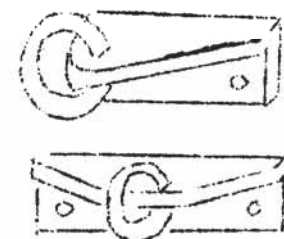

LOADING RINGS - This shows some of the styles of loading rings (or hook rings).

No's 1 and 2 are usually on the ends of the wagons.

No. 3 is used on polo and stringer wagons, and is often used on baggage wagons.

The rings usually are about 4 to 6 inches in diameter.

Brake, Foot Board & Loading Ring Data

DATE: 1950	SCALE: None	SCANNED & REVISED: 04/17/02	Pg 1 of 3
------------	-------------	--------------------------------	-----------

Circus Model Builders

Drawn By
Chet Slusser

DRAWING NUMBER

#0165

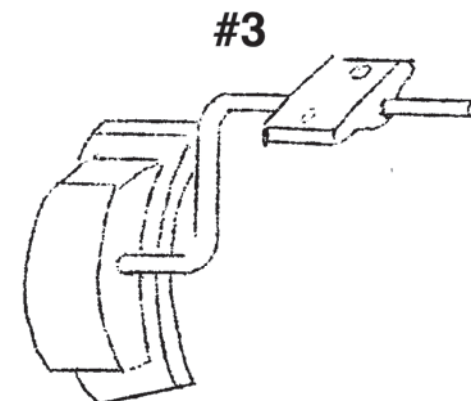
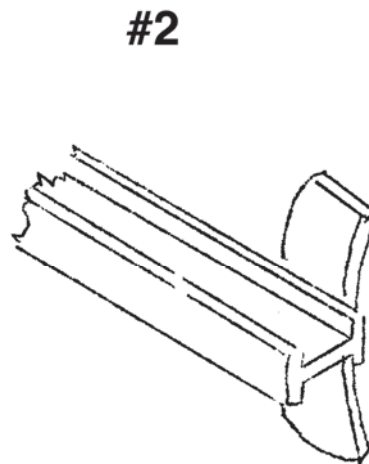
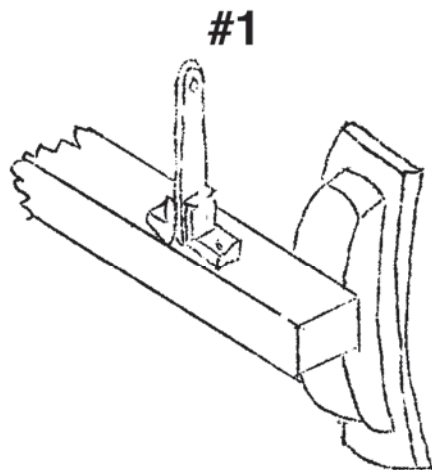

BRAKE SHOES - Those are the general types of brake shoes and beams. There are many variations in each type. Some beams are straight and some are tapered.

No.1 is a wood beam, with a wood block brake shoe, faced with iron.

No. 2 is an "I" beam with an iron shoe fastened direct to it. This type could also have a wood brake shoe.

No. 3 is mostly found on light wagons and cages. It is a steel rod with wood block shoe faced with iron.

Brake, Foot Board & Loading Ring Data			
Pg 2 of 3	SCALE: None	SCANNED & REVISED: 04/17/02	DRAWING NUMBER #0165

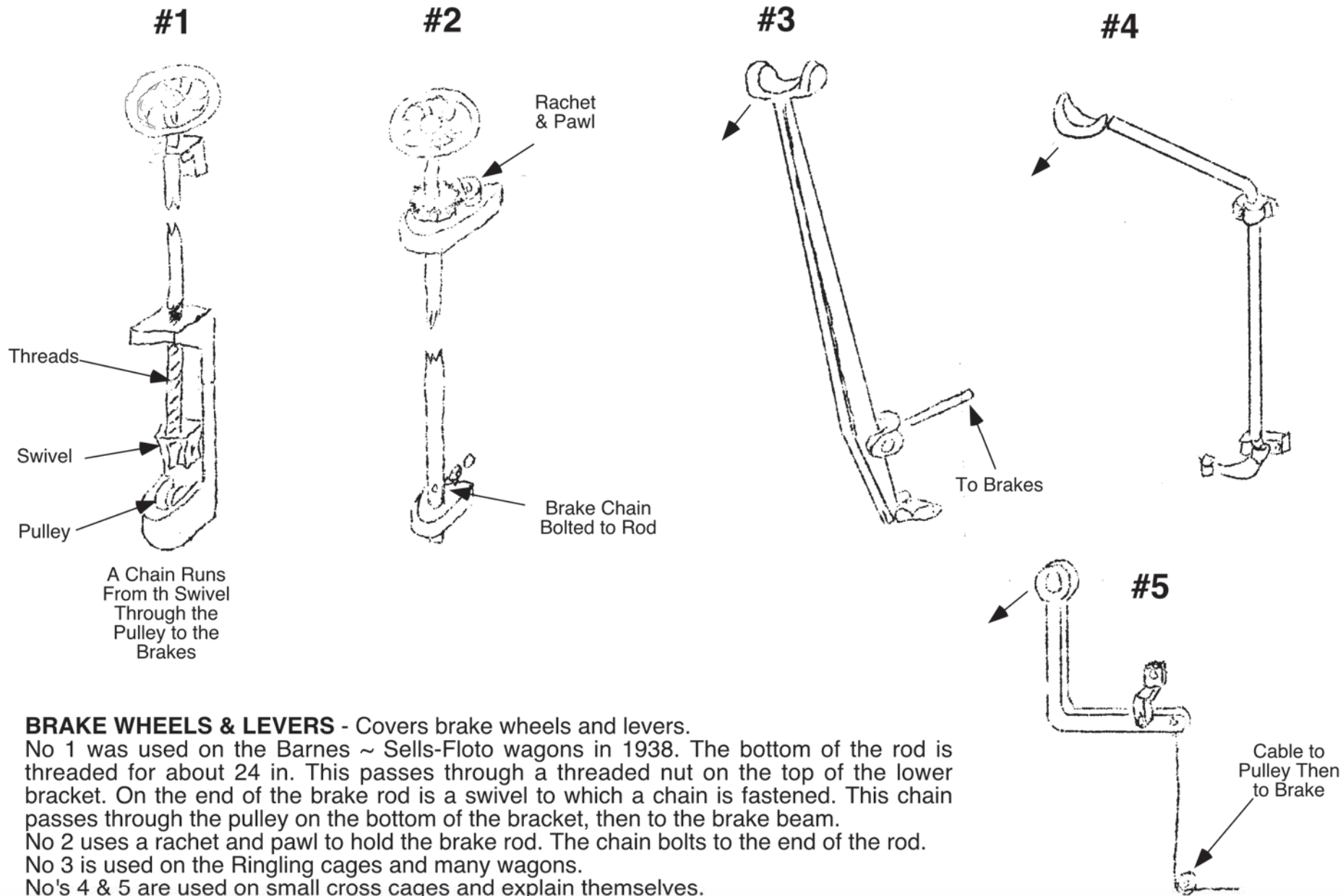

BRAKE WHEELS & LEVERS - Covers brake wheels and levers.

No 1 was used on the Barnes ~ Sells-Floto wagons in 1938. The bottom of the rod is threaded for about 24 in. This passes through a threaded nut on the top of the lower bracket. On the end of the brake rod is a swivel to which a chain is fastened. This chain passes through the pulley on the bottom of the bracket, then to the brake beam.

No 2 uses a rachet and pawl to hold the brake rod. The chain bolts to the end of the rod.

No 3 is used on the Ringling cages and many wagons.

No's 4 & 5 are used on small cross cages and explain themselves.

Brake, Foot Board & Loading Ring Data