

*Note:
This drawing was made from photos
from the Chet Slusser Collection and
notes from John Lower,*

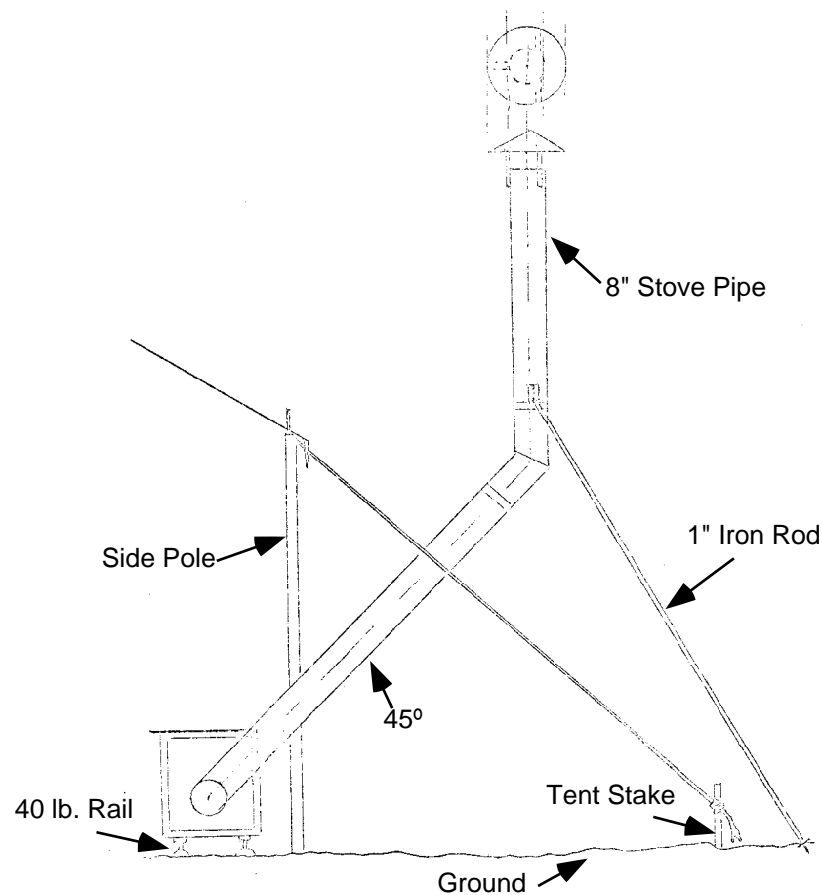

Cook Tent with Ranges

DATE: Unknown

SCALE: 1/4" = 1'

SCANNED & REVISED:
11/26/01

Pg 1 of 2

Circus Model Builders

Drawn By
Bill Cox

DRAWING NUMBER

#0160

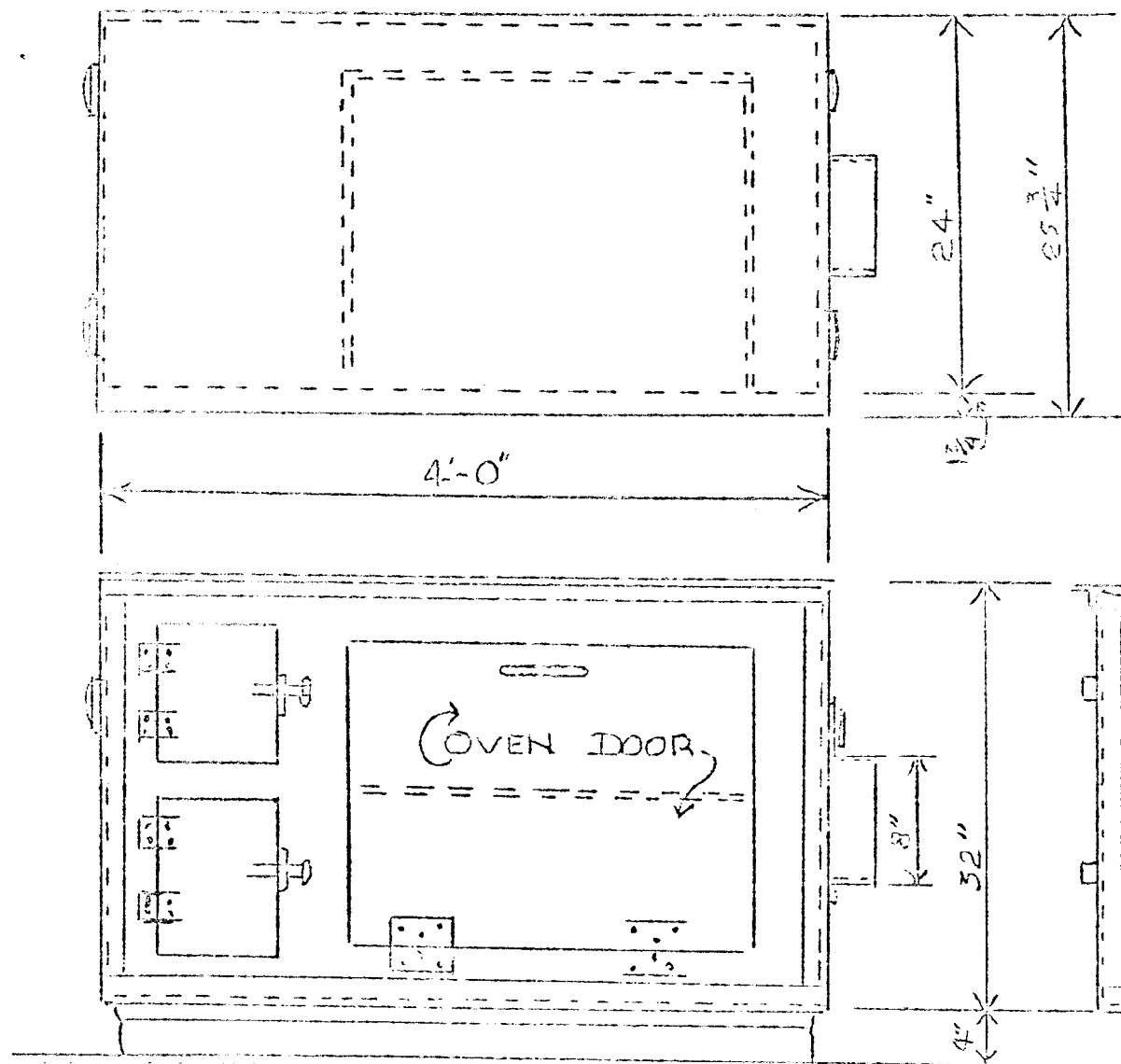

Cook Top Ranges

Notes:

The Front View is of the left hand range. Make the other one the opposite with the oven door and chimney connection on the other end so that two ranges can be set side by side with a :T" connection.

Front View

End View

Cook Tent with Ranges

DATE: Unknown

SCALE: 1" = 1'

SCANNED & REVISED:
11/26/01

Pg 2 of 2

Circus Model Builders

Drawn By
Bill Cox

DRAWING NUMBER

#0160