

DRAWING FOR A SPRING MAKING JIG

By Carl Block

Making metal springs for your wagons isn't the toughest job in the world, but getting them uniform so the wagon hangs straight is the rub. Here is a drawing of a jig that will make all your springs uniform. Naturally, you have to have 2 jigs, front & rear. It's a permanent part of your equipment so make it a metal jig. Standard cold rolled plate stock is sufficient and if you think you can't build a suitable jig, maybe a machinist friend will make them for you. Lay out an accurate pattern of the spring, if the contour block is not accurate, none of the springs will be either.

From your paper layout figure the length of each leaf, drill a small hole in the center. Slip top leaf on center pin of jig, form it to the contour block and form loop ends by rolling them around the hardened steel pins. Then slide each successive leaf on center pin and bend it to the form of the previous leaf.

After all leaves are formed, pull center pin out, then rivet leaves together thru center hole with copper or brass wire or rivets.

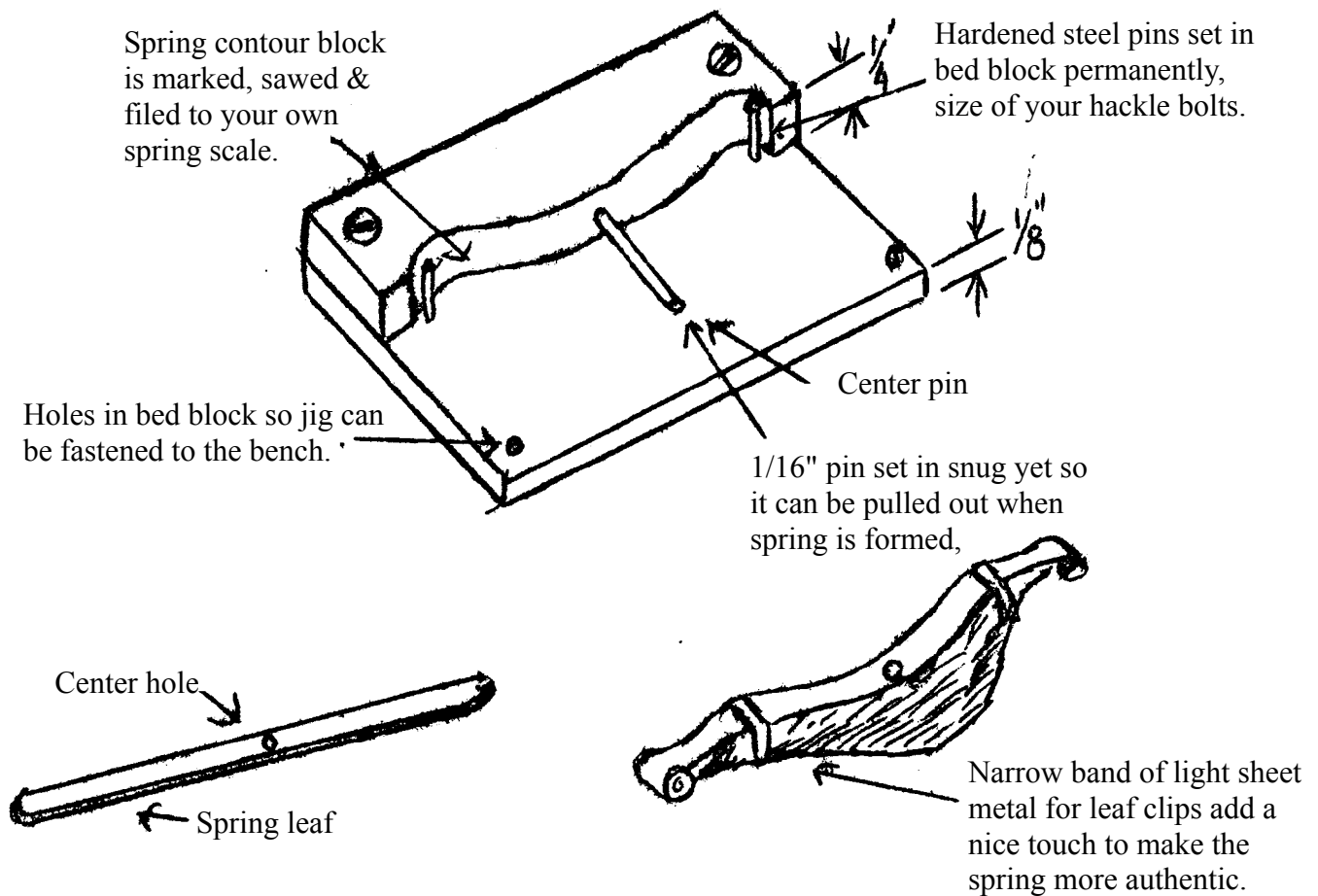

Leaf Spring Making Jig

DATE: None

SCALE: None

SCANNED & REVISED:
04/09/02

Pg 1 of 1

Circus Model Builders

Drawn By
Clark Bleck

DRAWING NUMBER

#0015